

# City of Mobridge

## Building Permit Application

Application Number \_\_\_\_\_

Date: \_\_\_\_\_

Property Owner _____	Phone Number _____	Address of Improvement _____
Mailing Address _____	Legal Description (Lot      Block      Subdivision) _____	
Email Address _____	Notes _____	
Contractor _____	Phone Number _____	

Type of Improvement	
<input type="checkbox"/> New Building	<input type="checkbox"/> Concrete Work
<input type="checkbox"/> Addition/Alteration	<input type="checkbox"/> Moving
<input type="checkbox"/> Repairs/Renovation	<input type="checkbox"/> Temporary

Describe proposed improvement in detail, including measurements.

Per Ordinance 868, a Temporary Buildings are: All storage structures which are used or manufactured to be of a temporary nature, such as storage containers, tents, soft covered shelters and other similar type storage structures and all other storage type structures which are not permanently affixed to the real estate by footings or foundations.

\$ _____	\$ _____	_____
Cost Estimate	Fee	Payment Type
<b>Fees: \$10 for the first \$1,000 of cost estimate. \$1.00 for each additional \$1,000. Temporary Building Permit - \$20 a year.</b>		

City Ordinance 9-6-1 Sidewalks, curbing with gutter and ramps are to be constructed on all lots within the City whenever a dwelling or building is constructed or placed upon a lot which fronts a Street or Avenue and shall be in accordance with the Americans Disabilities Act, City Ordinances, and Federal regulations. Such construction shall take place within 6 months of the earlier of occupancy or substantial completion of such dwelling or building. Failure to place sidewalk and/or curbing, gutter and ramps on or adjacent to the lot within the said 6 months shall constitute a violation of the building permit and said permit will be in violation and shall be subject to the City's general penalty clause. In addition, but not in limitation, failure to place sidewalk and/or curbing, gutter and ramps on or adjacent to the lot within the said 6 months shall constitute a Public Nuisance which shall permit the City to Abate the nuisance pursuant to the procedures defined in Chapter 5-5 and shall permit the City to recover the costs of Abatement by taxing the cost thereof by assessment against the real property on which the violation occurred pursuant to SDCL 21-10-6.

**Signature of Property Owner:** \_\_\_\_\_

**CHECK THE BOXES YOU REQUIRE.**

- Require water or sewer service, you must contact the Water/Waste Water Superintendent at 845-2102 for information on obtaining a Water/Sewer Permit.
- Doing electrical wiring on your residence or farmstead, you are required by state law to have Homeowner's Wiring Permit. You must contact SD Electrical Commission at 605-773-3573 or at [dlr.sd.gov/electrical/homeowner\\_wiring.aspx](http://dlr.sd.gov/electrical/homeowner_wiring.aspx) for permit application.
- Property Owner doing plumbing work at residence or farmstead, you are required by state law to have a Homeowner's Plumbing Permit. You must contact the SD State Plumbing Commission at 605-773-3429 or [dlr.sd.gov/plumbing/homeowner\\_plumbing.aspx](http://dlr.sd.gov/plumbing/homeowner_plumbing.aspx) for permit application.

I hereby certify that I have read and examined this application and know the same to be true and correct. All provisions of laws and ordinances governing this type of work will be complied with whether specified herein or not. The granting of a permit does not presume to give authority to violate or cancel the provisions of any other state or local law regulating construction or the performance of construction.

\_\_\_\_\_  
Signature of Property Owner

\_\_\_\_\_  
Date

**Approved By:**

Water/Waste Water Superintendent _____	Zoning Officer _____
Date _____	Date _____
Street Superintendent _____	Expiration Date _____
Date _____	

Description of Property: Locate all buildings, existing and proposed, showing dimensions between buildings and to property lines. be sure to indicate streets and alleys.

**AVENUE**

Curb

Curb

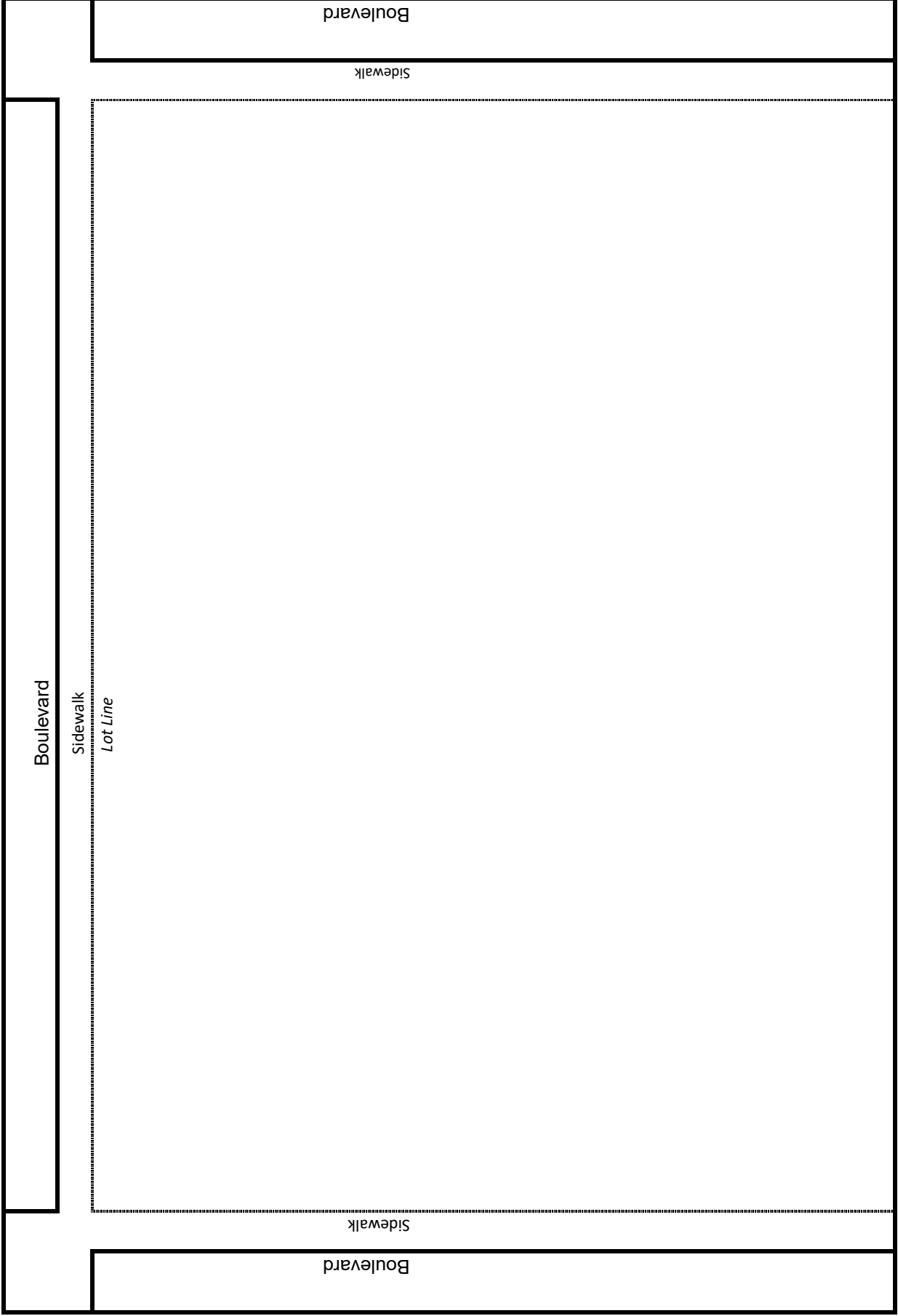

Boulevard

Sidewalk

Lot Line

**STREET**

Boulevard

Sidewalk

Boulevard

Sidewalk

**STREET**

Curb

Curb

**ALLEY**